

WBS NO: 2026CPT.01.01.20211, ETC.

CONTRACT: DA00652

**STATE OF NORTH CAROLINA
DIVISION OF HIGHWAYS**

CHOWAN

STATE	STATE PROJECT REFERENCE NUMBER	SHEET NO.
NC	2026CPT.01.01.20211, ETC.	1
STATE PROJECT NUMBER		DESCRIPTION
2026CPT.01.01.20211		P.E., CONST.

TYPE OF WORK: RESURFACING, SHOULDER RECONSTRUCTION, & PAVEMENT MARKINGS

MAP	ROUTE	FROM	TO
01	SR 1238 (Parrish Rd.)	SR 1225 (Nixon Rd.)	SR 1225 (Nixon Rd.)
02	SR 1312 (Center Hill Rd.)	SR 1002 (County Line Rd.)	Perquimans County Line

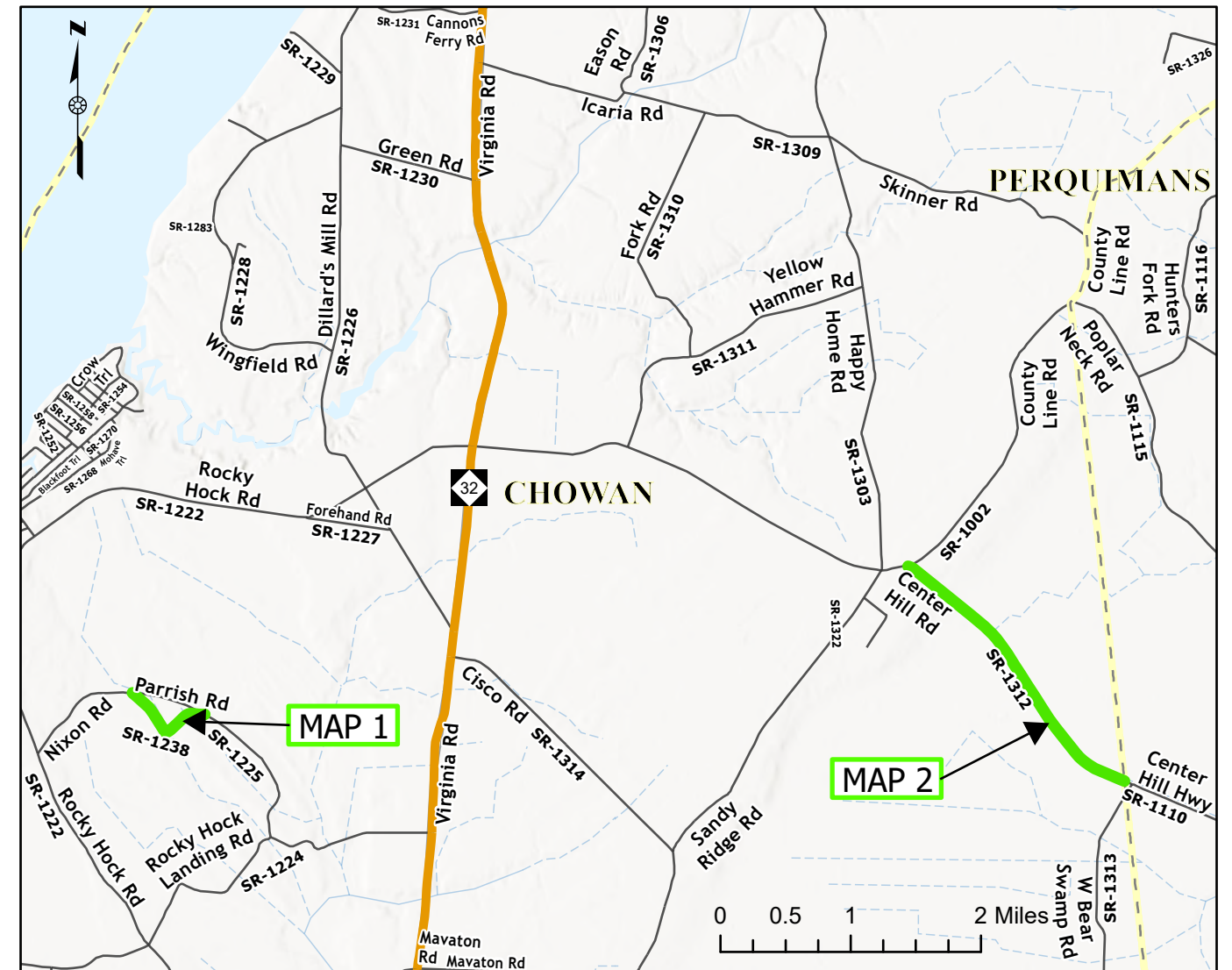

PROJECT LENGTH

MAP	MILES
01	0.61
02	1.923

Prepared in the Office of:
DIVISION OF HIGHWAYS
113 AIRPORT DR., EDENTON, NC 27932

B. N. BRASWELL, PE
DIV. PROJ. DEVELOPMENT ENGINEER

M. S. WINSLOW
DIVISION CONTRACT ENGINEER

W. B. HOBBS, P.E.
DIVISION PROJECT TEAM LEAD

D. H. STALLINGS
DIVISION DESIGN ENGINEER



WBS NO: 2026CPT.01.01.20211, ETC.

CONTRACT: DA00652

**STATE OF NORTH CAROLINA
DIVISION OF HIGHWAYS**

CHOWAN

STATE	STATE PROJECT REFERENCE NUMBER	SHEET NO.
NC	2026CPT.01.01.20211, ETC.	2
STATE PROJECT NUMBER		DESCRIPTION
2026CPT.01.01.20211		P.E., CONST.

TYPE OF WORK: MILLING, RESURFACING, SHOULDER RECONSTRUCTION, & PAVEMENT MARKINGS

MAP	ROUTE	FROM	TO
03	SR 1319 (Paradise Rd.)	SR 1316 (Greenhall Rd.)	Begin 3 Lane
04	SR 1319 (Paradise Rd.)	Begin 3 Lane	Begin C&G
05	SR 1319 (Paradise Rd.)	Begin C&G	US 17 BUS

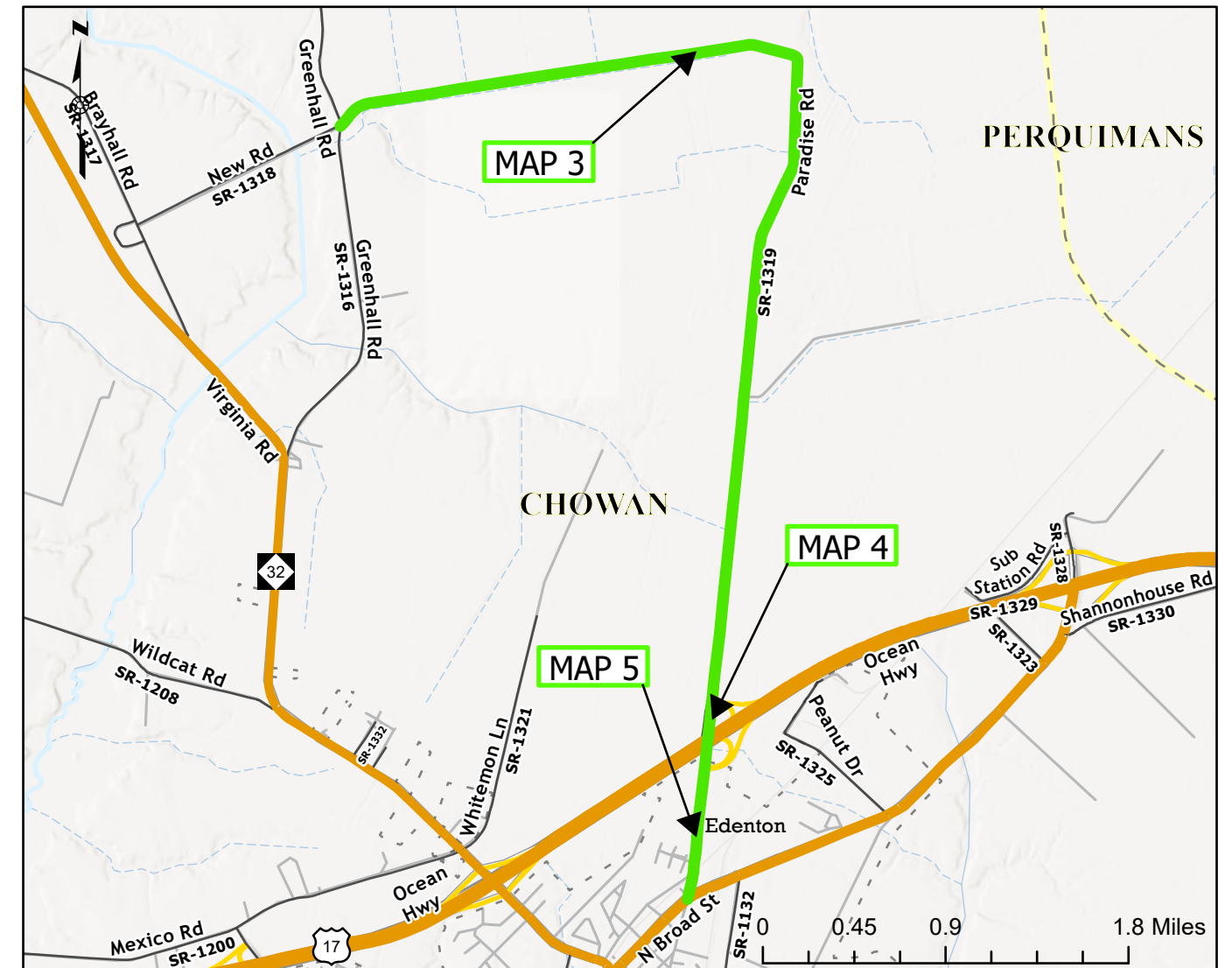

PROJECT LENGTH

MAP	MILES
03	4.365
04	0.4
05	0.499

Prepared in the Office of:
DIVISION OF HIGHWAYS
113 AIRPORT DR., EDENTON, NC 27932

B. N. BRASWELL, PE
DIV. PROJ. DEVELOPMENT ENGINEER

M. S. WINSLOW
DIVISION CONTRACT ENGINEER

W. B. HOBBS, PE
DIVISION PROJECT TEAM LEAD

D. H. STALLINGS
DIVISION DESIGN ENGINEER



WBS NO: 2026CPT.01.01.20211, ETC.

CONTRACT: DA00652

**STATE OF NORTH CAROLINA
DIVISION OF HIGHWAYS**

PERQUIMANS

STATE	STATE PROJECT REFERENCE NUMBER	SHEET NO.
NC	2026CPT.01.01.20211, ETC.	3
STATE PROJECT NUMBER		DESCRIPTION
2026CPT.01.01.20721		P.E., CONST.

TYPE OF WORK: RESURFACING, SHOULDER RECONSTRUCTION, & PAVEMENT MARKINGS

MAP	ROUTE	FROM	TO
06	SR 1101 (Bear Swamp Rd.)	RR	US 17
07	SR 1101 (Bear Swamp Rd.)	Chowan Co	RR

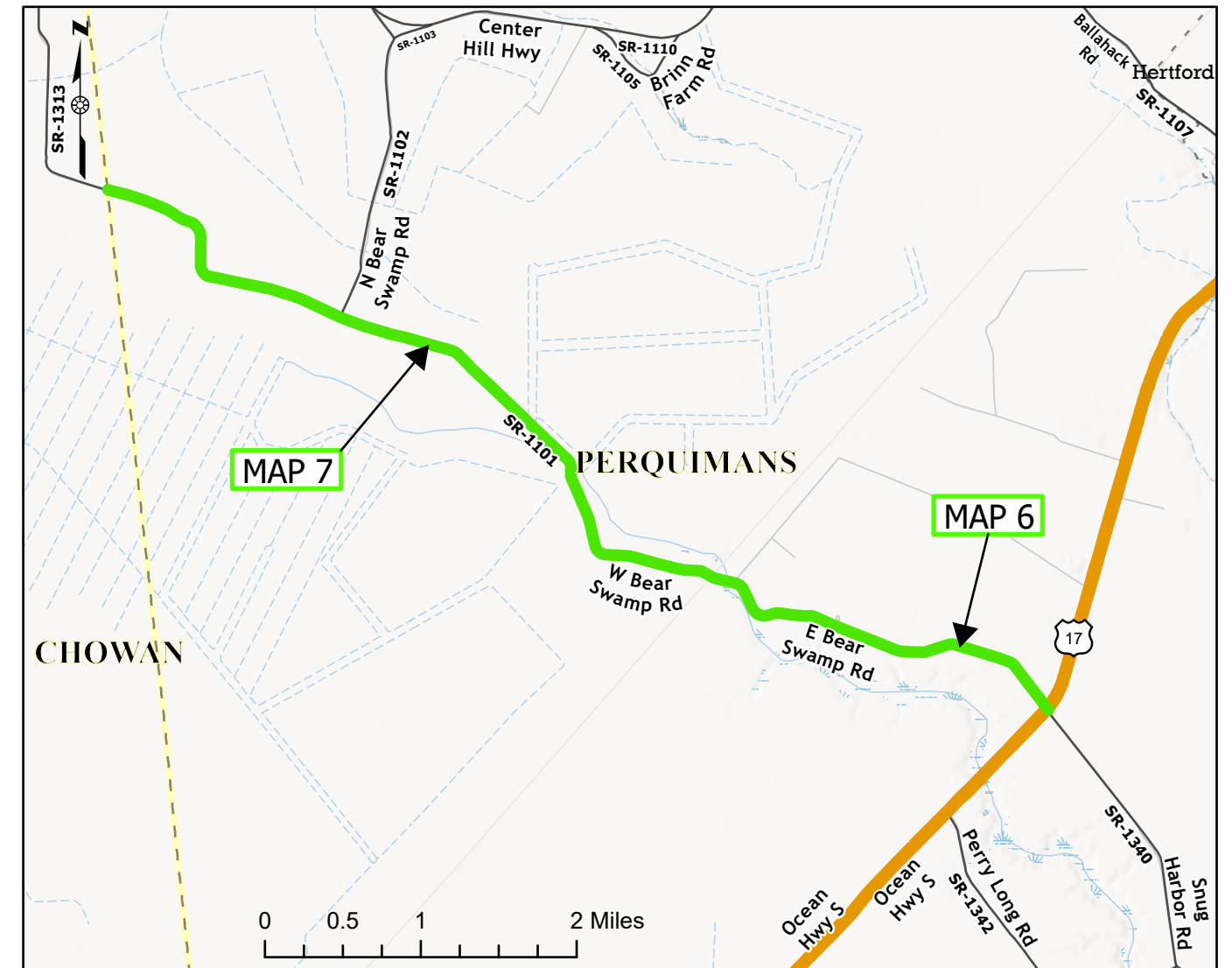

PROJECT LENGTH

MAP	MILES
06	2.02
07	4.037

Prepared in the Office of:
DIVISION OF HIGHWAYS
113 AIRPORT DR., EDENTON, NC 27932

B. N. BRASWELL, PE
DIV. PROJ. DEVELOPMENT ENGINEER

M. S. WINSLOW
DIVISION CONTRACT ENGINEER

W. B. HOBBS, PE
DIVISION PROJECT TEAM LEAD

D. H. STALLINGS
DIVISION DESIGN ENGINEER



PAVEMENT SCHEDULE

C1	PROP. APPROX. 1.5" ASPHALT CONCRETE SURFACE COURSE, TYPE S9.5B, AT AN AVERAGE RATE OF 165 LBS. PER SQ. YD.
U	EXISTING PAVEMENT
T	SHOULDER RECONSTRUCTION
V1	INCIDENTAL MILLING

NOTES:

- * ALL INTERSECTING ROADS ARE TO BE RESURFACED TO THE ENDS OF THEIR RADII, THE MAIN LINE RIGHT OF WAY OR AS DIRECTED BY THE ENGINEER. THIS SHALL INCLUDE ANY TAPERS AND TURN LANES LOCATED BOTH ON THE MAIN LINE OR INTERSECTING PAVED ROADWAY.
- * EDGES, PAVEMENT WIDENING, INTERSECTIONS AND BRIDGE FLARES ARE INCLUDED IN THE SUMMARY OF QUANTITIES.
- * 1.5" OF S9.5B TO BE APPLIED THE FULL WIDTH OF THE ROADWAY
- * CONTRACTOR SHALL PERFORM PATCHING EXISTING PAVEMENT, FULL DEPTH BEFORE APPLICATION OF 1.5" OF S9.5B

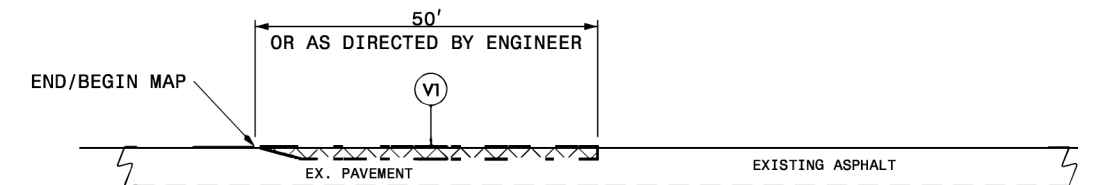
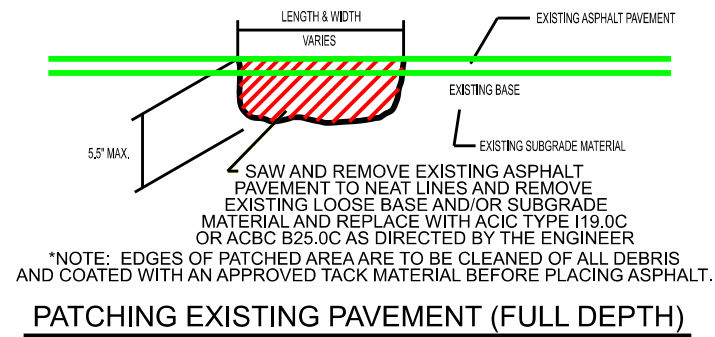

DETAIL 1
MAIN LINE MILLING

NOTE:
1. INCLUDES INCIDENTAL MILLING AT THE ENDS OF MAIN LINE SECTIONS, OR AS DIRECTED BY THE ENGINEER.
2. PAVE TO THE END OF THE MILLED SURFACE TO CREATE A SMOOTH TRANSITION.

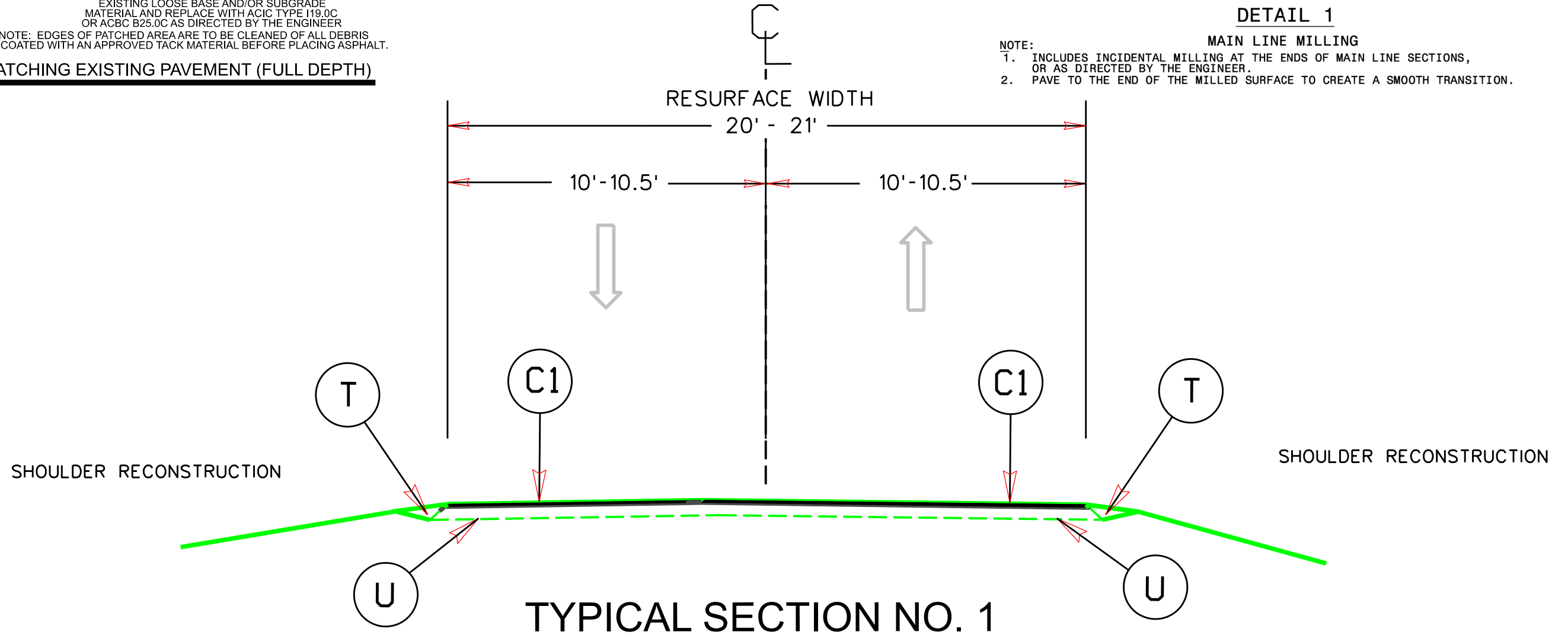

TYPICAL SECTION NO. 1

USE WITH MAPS 1 - 3 & 6 - 7

SYSTEMS DESIGN

PAVEMENT SCHEDULE

C1	PROP. APPROX. 1.5" ASPHALT CONCRETE SURFACE COURSE, TYPE S9.5B, AT AN AVERAGE RATE OF 165 LBS. PER SQ. YD.
U	EXISTING PAVEMENT
T	SHOULDER RECONSTRUCTION
V1	INCIDENTAL MILLING
V2	MILLING ASPHALT PAVEMENT, 1.5" DEPTH

NOTES:

- * ALL INTERSECTING ROADS ARE TO BE RESURFACED TO THE ENDS OF THEIR RADII, THE MAIN LINE RIGHT OF WAY OR AS DIRECTED BY THE ENGINEER. THIS SHALL INCLUDE ANY TAPERS AND TURN LANES LOCATED BOTH ON THE MAIN LINE OR INTERSECTING PAVED ROADWAY.
- * EDGES, PAVEMENT WIDENING, INTERSECTIONS AND BRIDGE FLARES ARE INCLUDED IN THE SUMMARY OF QUANTITIES.
- * 1.5" OF S9.5B TO BE APPLIED THE FULL WIDTH OF THE ROADWAY
- * CONTRACTOR SHALL PERFORM PATCHING EXISTING PAVEMENT, FULL DEPTH BEFORE APPLICATION OF 1.5" OF S9.5B
- * SHOULDER WEDGE SHALL BE USED ON ALL ROADS 22' OR WIDER OR AS DIRECTED BY THE ENGINEER

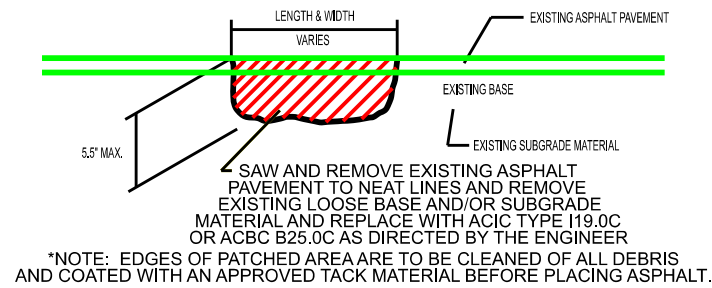

PATCHING EXISTING PAVEMENT (FULL DEPTH)

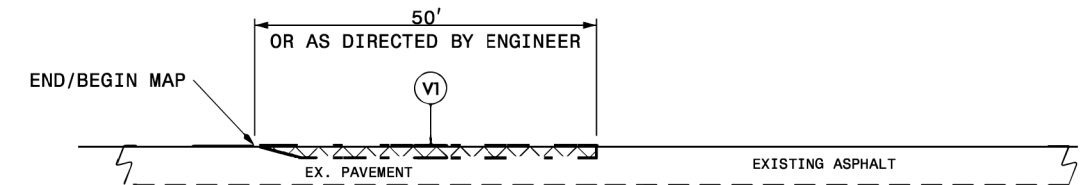

DETAIL 1

MAIN LINE MILLING

- NOTE:
1. INCLUDES INCIDENTAL MILLING AT THE ENDS OF MAIN LINE SECTIONS, OR AS DIRECTED BY THE ENGINEER.
 2. PAVE TO THE END OF THE MILLED SURFACE TO CREATE A SMOOTH TRANSITION.

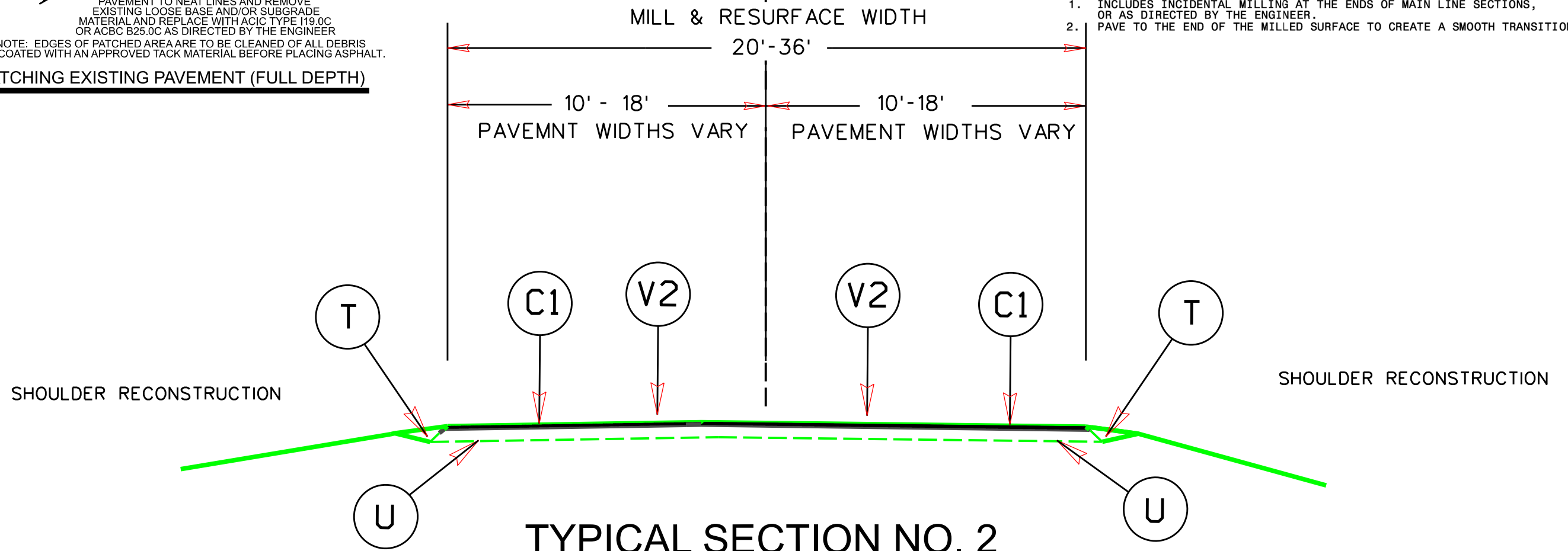

TYPICAL SECTION NO. 2

USE WITH MAP 4

SYSTEMS DESIGN

NTS

PAVEMENT SCHEDULE

C1	PROP. APPROX. 1.5" ASPHALT CONCRETE SURFACE COURSE, TYPE S9.5B, AT AN AVERAGE RATE OF 165 LBS. PER SQ. YD.
V1	INCIDENTAL MILLING
V2	MILLING ASPHALT PAVEMENT, 1.5" DEPTH
U	EXISTING PAVEMENT

NOTES:

- * ALL INTERSECTING ROADS ARE TO BE RESURFACED TO THE ENDS OF THEIR RADII, THE MAIN LINE RIGHT OF WAY OR AS DIRECTED BY THE ENGINEER. THIS SHALL INCLUDE ANY TAPERS AND TURN LANES LOCATED BOTH ON THE MAIN LINE OR INTERSECTING PAVED ROADWAY.
- * EDGES, PAVEMENT WIDENING, INTERSECTIONS AND BRIDGE FLARES ARE INCLUDED IN THE SUMMARY OF QUANTITIES.
- * 1.5" OF S9.5B TO BE APPLIED THE FULL WIDTH OF THE ROADWAY
- * CONTRACTOR SHALL PERFORM PATCHING EXISTING PAVEMENT, FULL DEPTH BEFORE APPLICATION OF 1.5" OF S9.5B

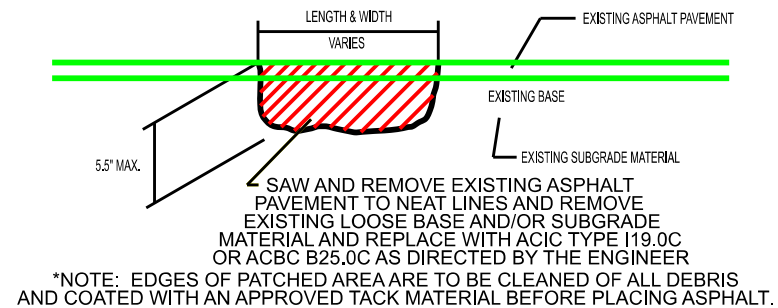

PATCHING EXISTING PAVEMENT (FULL DEPTH)

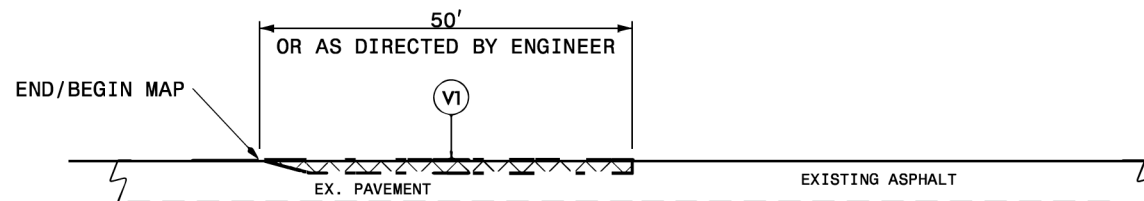

DETAIL 1

MAIN LINE MILLING

- NOTE:
1. INCLUDES INCIDENTAL MILLING AT THE ENDS OF MAIN LINE SECTIONS, OR AS DIRECTED BY THE ENGINEER.
 2. PAVE TO THE END OF THE MILLED SURFACE TO CREATE A SMOOTH TRANSITION.

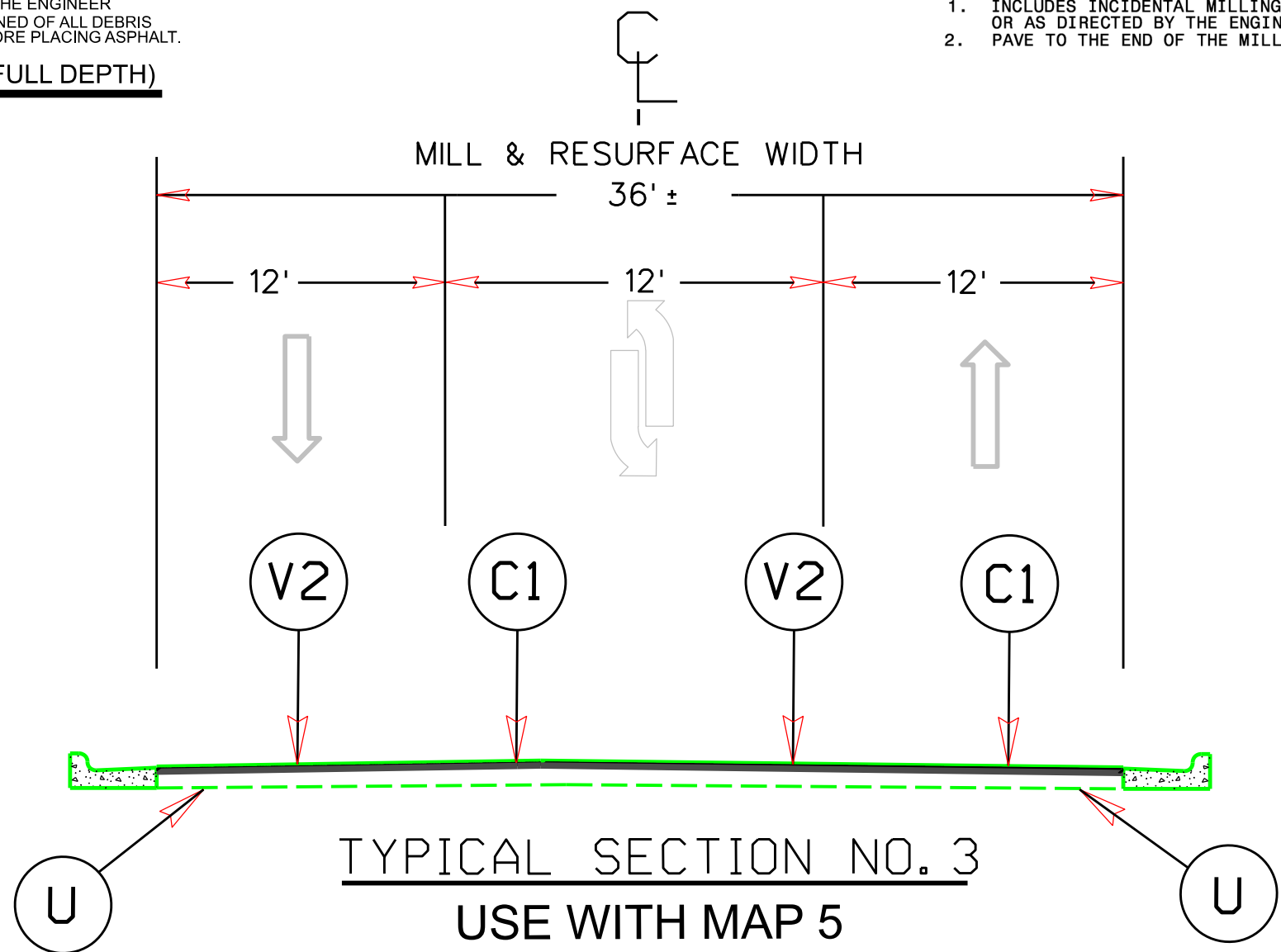

TYPICAL SECTION NO. 3
USE WITH MAP 5

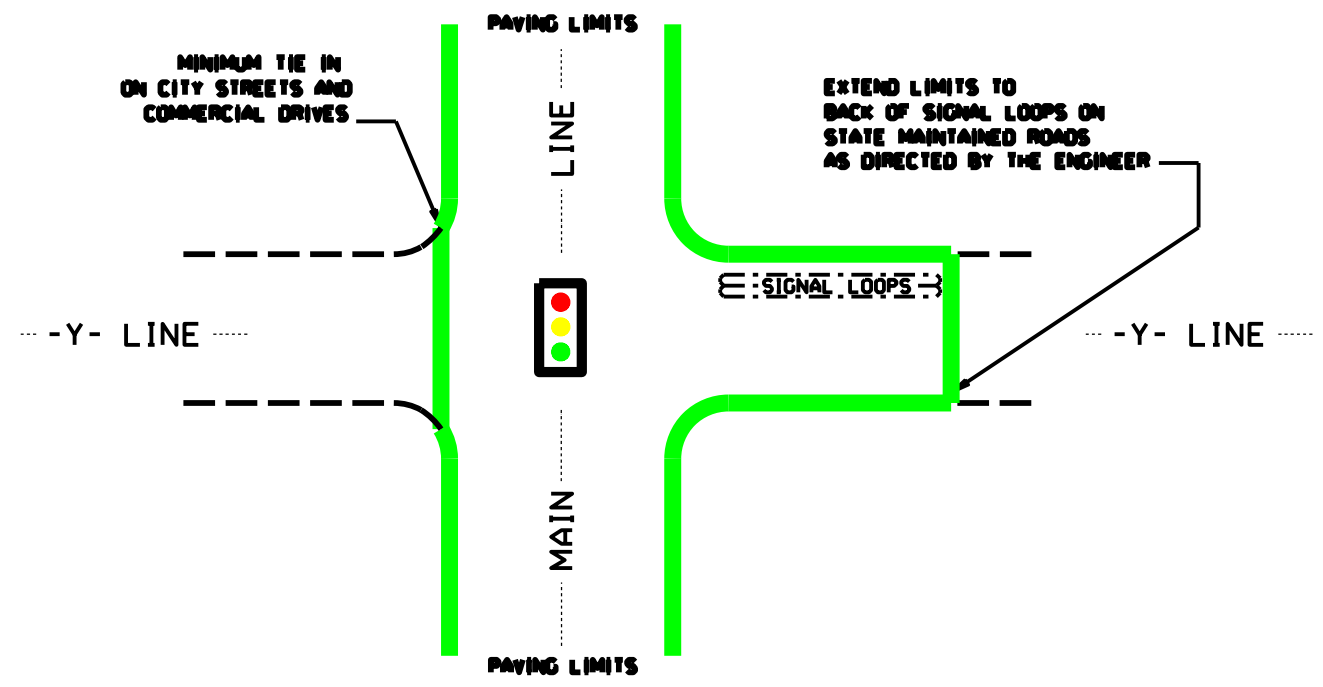

TYPICAL DETAIL OF PROJECT LIMITS AT SIGNALIZED Y LINES

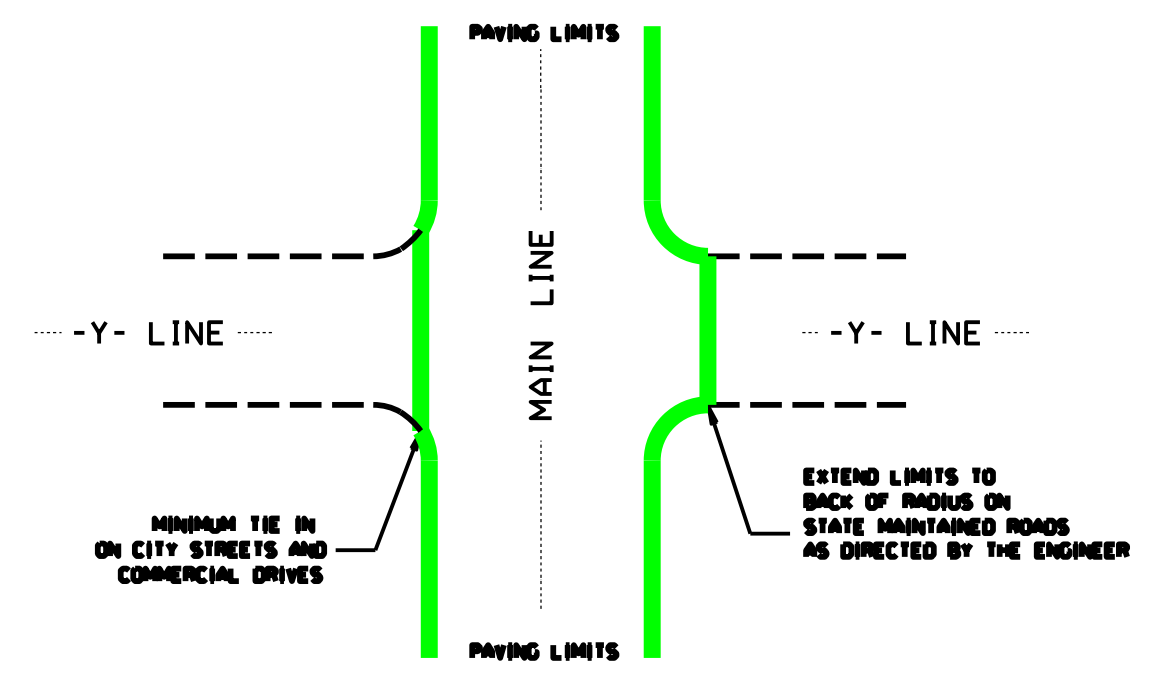

TYPICAL DETAIL OF PROJECT LIMITS AT UNSIGNALIZED Y LINES

ADDITIONAL INTERSECTIONS (NON-TYPICAL)		
Extend paving limits to back of radius or loop on the following intersections:		
MAP#	STREET NAME	COMMENTS
	PAVE ALL STATE OWNED & TOWN STREETS TO BACK OF RADIUS FOR THIS PROJECT	

PROJECT NO.	SHEET NO.	TOTAL NO.
2026CPT.01.01.20211, ETC.	7	

SUMMARY OF QUANTITIES

PROJECT NO	COUNTY	MAP NO	ROUTE	DESCRIPTION	TYP NO	LANES	LANE TYPE	LENGTH	WIDTH	BEGIN MP	END MP	0000100000-N	0106000000-E	1220000000-E	1245000000-E	1260000000-E	1297000000-E	1330000000-E	1519000000-E	1575000000-E
												MOBILIZATION	BORROW EXCAVATION	INCIDENTAL STONE BASE	SHOULDER RECONSTRUCTION	AGGREGATE SHOULDER BORROW	MILLING ASPHALT PAVEMENT (1½")	INCIDENTAL MILLING	ASPHALT CONC SURFACE COURSE, S9.5B	ASPHALT BINDER FOR PLANT MIX
												LS	CY	TONS	SMI	TON	SY	SY	TONS	TONS
2026CPT.01.01.20211	Chowan	1	SR-1238 / PARRISH RD	FROM SR 1225 (NIXON RD.) TO SR 1225 (NIXON RD.)		2	2WU	0.61	21	0	0.61	1	110	15	1.22	6			686	45
TOTAL FOR MAP NO. 1								0.61				*	110	15	1.22	6			686	45
2026CPT.01.01.20211	Chowan	2	SR-1312 / CENTER HILL RD	FROM SR 1002 (COUNTY LINE RD.) TO PERQUIMANS COUNTY LINE		2	2WU	1.923	20	0	1.923	*	346	26	3.85	24			2,060	140
TOTAL FOR MAP NO. 2								1.923				*	346	26	3.85	24			2,060	140
2026CPT.01.01.20211	Chowan	3	SR-1319 / PARADISE RD	FROM SR 1316 (GREENHALL RD.) TO BEGIN 3 LANE		2	2WU	4.365	21	0	4.365	*	786	54	8.73	32			4,909	324
TOTAL FOR MAP NO. 3								4.365				*	786	54	8.73	32			4,909	324
2026CPT.01.01.20211	Chowan	4	SR-1319 / PARADISE RD	FROM BEGIN 3 LANE TO BEGIN C&G		3	2WU	0.4	36	4.365	4.765	*				4	6,845	1,974	668	45
TOTAL FOR MAP NO. 4								0.4				*				4	6,845	1,974	668	45
2026CPT.01.01.20211	Chowan	5	SR-1319 / PARADISE RD	FROM BEGIN C&G TO US 17		3	2WU	0.499	36	4.765	5.264	*					10,539	255	983	65
TOTAL FOR MAP NO. 5								0.499				*					10,539	255	983	65
TOTAL FOR PROJ NO. 2026CPT.01.01.20211								7.797				*	1,242	95	13.80	66	17,384	2,229	9,306	619
2026CPT.01.01.20211	Perquimans	6	SR-1101 / E BEAR SWAMP RD/W BEAR SWAMP RD	FROM RR TO US 17		2	2WU	2.02	20	0	2.02	*	364	20	4.04	16		15	2,164	144
TOTAL FOR MAP NO. 6								2.02				*	364	20	4.04	16		15	2,164	144
2026CPT.01.01.20211	Perquimans	7	SR-1101 / W BEAR SWAMP RD	FROM CHOWAN CO TO RR		2	2WU	4.037	20	2.02	6.057	*	727	37	8.07	32		15	4,325	284
TOTAL FOR MAP NO. 7								4.037				*	727	37	8.07	32		15	4,325	284
TOTAL FOR PROJ NO. 2026CPT.01.01.20211								6.057				*	1,091	57	12.11	48		30	6,489	428
GRAND TOTAL								13.854				1	2,333	152	25.91	114	17,384	2,259	15,795	1,047

SUMMARY OF QUANTITIES

PROJECT NO	COUNTY	MAP NO	ROUTE	DESCRIPTION	TYP NO	LANES	LANE TYPE	LENGTH	WIDTH	BEGIN MP	END MP	1705000000-E	2549000000-E	3030000000-E	3210000000-N	3287000000-N	3319000000-N	3360000000-E	6084000000-E	6117000000-N	
												PATCHING EXISTING PAVEMENT (FULL DEPTH)	2'-6" CONCRETE CURB & GUTTER	STEEL BEAM GUARDRAIL	GR ANCH CAT-1	GUARDRAIL END UNITS, TYPE TL-3 (SP)	GUARDRAIL ANCHOR UNITS, TYPE B-83	REM EXT GRDRL	SEEDING & MULCHING	RESPONSE FOR EROSION CONTROL	
												TON	LF	LF	EA	EA	EA	LF	ACR	EA	
2026CPT.01.01.20211	Chowan	1	SR-1238 / PARRISH RD	FROM SR 1225 (NIXON RD.) TO SR 1225 (NIXON RD.)		2	2WU	0.61	21	0	0.61	4							0.6		
TOTAL FOR MAP NO. 1								0.61				4							0.6		
2026CPT.01.01.20211	Chowan	2	SR-1312 / CENTER HILL RD	FROM SR 1002 (COUNTY LINE RD.) TO PERQUIMANS COUNTY LINE		2	2WU	1.923	20	0	1.923	117							1.9	1	
TOTAL FOR MAP NO. 2								1.923				117							1.9	1	
2026CPT.01.01.20211	Chowan	3	SR-1319 / PARADISE RD	FROM SR 1316 (GREENHALL RD.) TO BEGIN 3 LANE		2	2WU	4.365	21	0	4.365	100							4.2	1	
TOTAL FOR MAP NO. 3								4.365				100							4.2	1	
2026CPT.01.01.20211	Chowan	4	SR-1319 / PARADISE RD	FROM BEGIN 3 LANE TO BEGIN C&G		3	2WU	0.4	36	4.365	4.765	41		1,473	2.00	2	4	1,686.00			
TOTAL FOR MAP NO. 4								0.4				41		1,473	2.00	2	4	1,686.00			
2026CPT.01.01.20211	Chowan	5	SR-1319 / PARADISE RD	FROM BEGIN C&G TO US 17		3	2WU	0.499	36	4.765	5.264	15	20								
TOTAL FOR MAP NO. 5								0.499				15	20								
TOTAL FOR PROJ NO. 2026CPT.01.01.20211								7.797				277	20	1,473	2.00	2	4	1,686.00		6.7	2
2026CPT.01.01.20211	Perquimans	6	SR-1101 / E BEAR SWAMP RD/W BEAR SWAMP RD	FROM RR TO US 17		2	2WU	2.02	20	0	2.02	72							2.0	1	
TOTAL FOR MAP NO. 6								2.02				72							2.0	1	
2026CPT.01.01.20211	Perquimans	7	SR-1101 / W BEAR SWAMP RD	FROM CHOWAN CO TO RR		2	2WU	4.037	20	2.02	6.057	67							3.9		
TOTAL FOR MAP NO. 7								4.037				67							3.9		
TOTAL FOR PROJ NO. 2026CPT.01.01.20211								6.057				139								5.9	1
GRAND TOTAL								13.854				416	20	1,473	2.00	2	4	1,686.00		12.6	3

PROJECT NO.	SHEET NO.	TOTAL NO.
2026CPT.01.01.20211, ETC.	8	

THERMOPLASTIC AND PAINT QUANTITIES

PROJECT NO	COUNTY	MAP NO	ROUTE	DESCRIPTION	TYP NO	LANES	LANE TYPE	LENGTH	WIDTH	BEGIN MP	END MP	4413000000-E	4457000000-N	4709000000-E	4720000000-E	4725000000-E		4810000000-E	
												WORK ZONE ADVANCE/GENERAL WARNING SIGNING	TEMPORARY TRAFFIC CONTROL (SP)	THERMO PAVEMENT MARKING LINES (24" 90 MILS) (SP)	THERMOPLASTIC PAVEMENT MARKING CHARACTER (90 MILS), RXR	THERMOPLASTIC PAVEMENT MARKING SYMBOL (90 MILS), LT ARROW	THERMOPLASTIC PAVEMENT MARKING SYMBOL (90 MILS), STR & RT ARROW	PAINT PAVEMENT MARKING LINES (4") WHITE	PAINT PAVEMENT MARKING LINES (4") YELLOW
												SF	LS	LF	EA	EA	EA	LF	LF
2026CPT.01.01.20211	Chowan	1	SR-1238 / PARRISH RD	FROM SR 1225 (NIXON RD.) TO SR 1225 (NIXON RD.)		2	2WU	0.61	21	0	0.61		1					6,442	6,442
TOTAL FOR MAP NO. 1								0.61					*					6,442	6,442
2026CPT.01.01.20211	Chowan	2	SR-1312 / CENTER HILL RD	FROM SR 1002 (COUNTY LINE RD.) TO PERQUIMANS COUNTY LINE		2	2WU	1.923	20	0	1.923	86	*					20,307	12,692
TOTAL FOR MAP NO. 2								1.923				86	*					20,307	12,692
2026CPT.01.01.20211	Chowan	3	SR-1319 / PARADISE RD	FROM SR 1316 (GREENHALL RD.) TO BEGIN 3 LANE		2	2WU	4.365	21	0	4.365	123	*					46,094	28,809
TOTAL FOR MAP NO. 3								4.365				123	*					46,094	28,809
2026CPT.01.01.20211	Chowan	4	SR-1319 / PARADISE RD	FROM BEGIN 3 LANE TO BEGIN C&G		3	2WU	0.4	36	4.365	4.765	32	*			3		4,224	4,224
TOTAL FOR MAP NO. 4								0.4				32	*		3		4,224	4,224	
2026CPT.01.01.20211	Chowan	5	SR-1319 / PARADISE RD	FROM BEGIN C&G TO US 17		3	2WU	0.499	36	4.765	5.264	27	*	22		17	1	150	13,200
TOTAL FOR MAP NO. 5								0.499				27	*	22		17	1	150	13,200
TOTAL FOR PROJ NO. 2026CPT.01.01.20211								7.797				268	*	22		20	1	77,217	65,367
												21		142,584					
2026CPT.01.01.20211	Perquimans	6	SR-1101 / E BEAR SWAMP RD/W BEAR SWAMP RD	FROM RR TO US 17		2	2WU	2.02	20	0	2.02	86	*	86	6			21,331	13,332
TOTAL FOR MAP NO. 6								2.02				86	*	86	6			21,331	13,332
2026CPT.01.01.20211	Perquimans	7	SR-1101 / W BEAR SWAMP RD	FROM CHOWAN CO TO RR		2	2WU	4.037	20	2.02	6.057	118	*	86	6			42,631	26,644
TOTAL FOR MAP NO. 7								4.037				118	*	86	6			42,631	26,644
TOTAL FOR PROJ NO. 2026CPT.01.01.20211								6.057				204	*	172	12			63,962	39,976
												103,938							
GRAND TOTAL								13.854				472	1	194	12	20	1	141,179	105,343
												21		246,522					

THERMOPLASTIC AND PAINT QUANTITIES

PROJECT NO	COUNTY	MAP NO	ROUTE	DESCRIPTION	TYP NO	LANES	LANE TYPE	LENGTH	WIDTH	BEGIN MP	END MP	4830000000-E	4835000000-E	4840000000-N	4845000000-N		4890000000-E		4704000000-N
												PAINT PAVEMENT MARKING LINES (16")	PAINT PAVEMENT MARKING LINES (24")	PAINT PAVEMENT MARKING CHARACTER (MSG RXR)	PAINT PAVEMENT MARKING SYMBOL (LT ARROW)	PAINT PAVEMENT MARKING SYMBOL (STR & RT ARROW)	HOT SPRAY THERMOPLASTIC PAVEMENT MARKING LINES, (4", 65 MILS) WHITE	HOT SPRAY THERMOPLASTIC PAVEMENT MARKING LINES, (4", 65 MILS) YELLOW	THERMOPLASTIC PAVEMENT MARKING LINES (16", 90 MILS)
												LF	LF	EA	EA	EA	LF	LF	LF
2026CPT.01.01.20211	Chowan	1	SR-1238 / PARRISH RD	FROM SR 1225 (NIXON RD.) TO SR 1225 (NIXON RD.)		2	2WU	0.61	21	0	0.61							6,442	6,442
TOTAL FOR MAP NO. 1								0.61										6,442	6,442
2026CPT.01.01.20211	Chowan	2	SR-1312 / CENTER HILL RD	FROM SR 1002 (COUNTY LINE RD.) TO PERQUIMANS COUNTY LINE		2	2WU	1.923	20	0	1.923							20,307	12,692
TOTAL FOR MAP NO. 2								1.923										20,307	12,692
2026CPT.01.01.20211	Chowan	3	SR-1319 / PARADISE RD	FROM SR 1316 (GREENHALL RD.) TO BEGIN 3 LANE		2	2WU	4.365	21	0	4.365							46,094	28,809
TOTAL FOR MAP NO. 3								4.365										46,094	28,809
2026CPT.01.01.20211	Chowan	4	SR-1319 / PARADISE RD	FROM BEGIN 3 LANE TO BEGIN C&G		3	2WU	0.4	36	4.365	4.765				3			4,224	4,224
TOTAL FOR MAP NO. 4								0.4						3		4,224	4,224		
2026CPT.01.01.20211	Chowan	5	SR-1319 / PARADISE RD	FROM BEGIN C&G TO US 17		3	2WU	0.499	36	4.765	5.264			22	17	1		150	13,200
TOTAL FOR MAP NO. 5								0.499				22	17	1		150	13,200		
TOTAL FOR PROJ NO. 2026CPT.01.01.20211								7.797				22		20	1	77,217	65,367		
												21		142,584					
2026CPT.01.01.20211	Perquimans	6	SR-1101 / E BEAR SWAMP RD/W BEAR SWAMP RD	FROM RR TO US 17		2	2WU	2.02	20	0	2.02	184	86	6				21,331	13,332
TOTAL FOR MAP NO. 6								2.02				184	86	6			21,331	13,332	
2026CPT.01.01.20211	Perquimans	7	SR-1101 / W BEAR SWAMP RD	FROM CHOWAN CO TO RR		2	2WU	4.037	20	2.02	6.057	184	86	6				42,631	26,644
TOTAL FOR MAP NO. 7								4.037				184	86	6			42,631	26,644	
TOTAL FOR PROJ NO. 2026CPT.01.01.20211								6.057				368	172	12			63,962	39,976	
												103,938							
GRAND TOTAL								13.854				368	194	12	20	1	141,179	105,343	
												21		246,522					

NOTES: Less than 5' - 10' undisturbed buffer from ROW, ditchline, water feature, or drainage inlet, add BMP.

BMP Options: Wattle or Silt Fence

EROSION CONTROL DETAIL

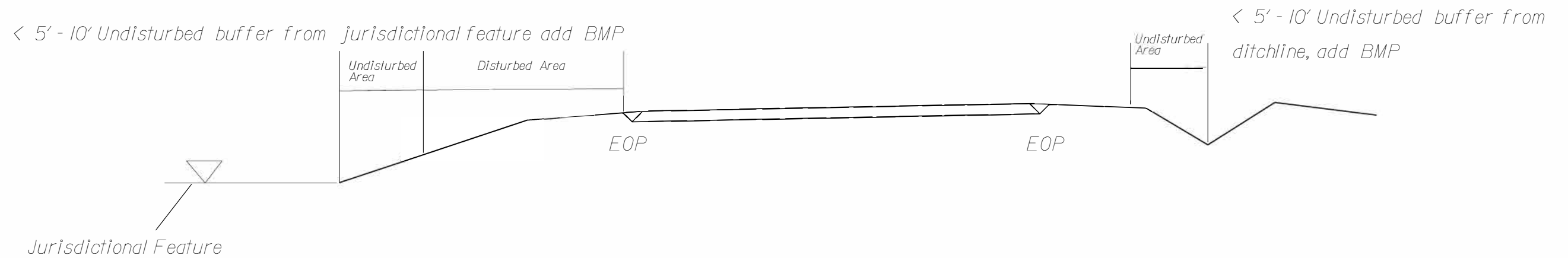
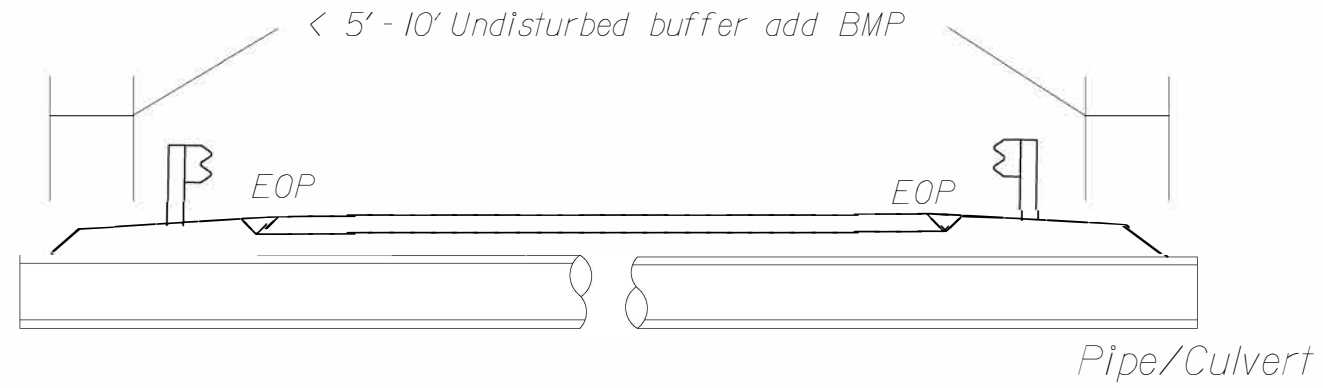

Use BMP's if shoulders and/or frontslopes and/or ditchline and/or backslopes are disturbed

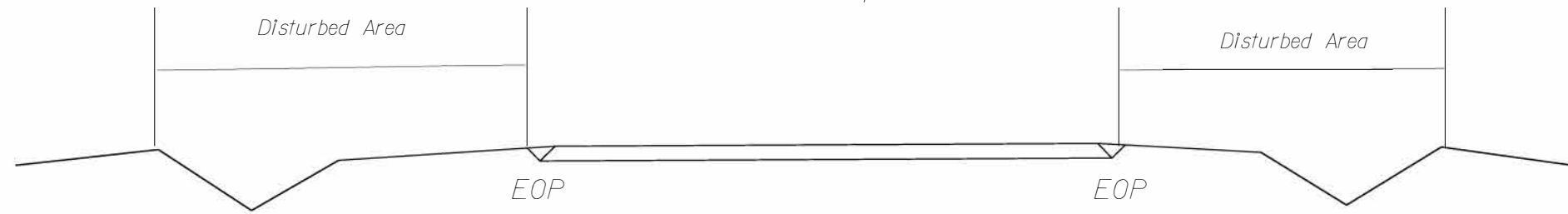

< 5' - 10' Undisturbed buffer from inlet, add wattle

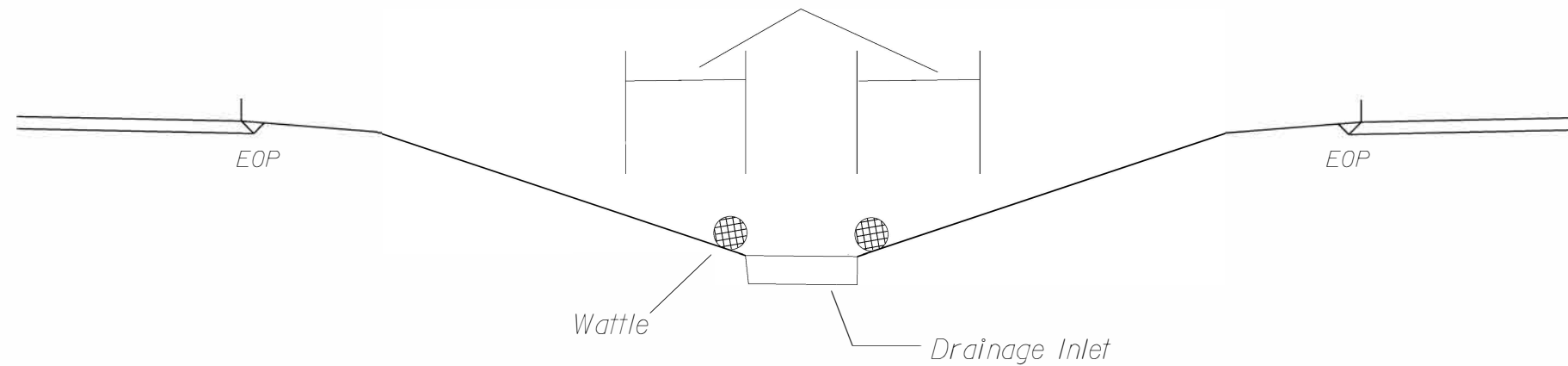

NOT TO SCALE

DIVISION OF HIGHWAYS
STATE OF NORTH CAROLINA

SOIL STABILIZATION TIMEFRAMES

SITE DESCRIPTION	STABILIZATION TIME	TIMEFRAME EXCEPTIONS
PERIMETER DIKES, SWALES, DITCHES AND SLOPES	7 DAYS	NONE
HIGH QUALITY WATER (HQW) ZONES	7 DAYS	NONE
SLOPES STEEPER THAN 3:1	7 DAYS	IF SLOPES ARE 10' OR LESS IN LENGTH AND ARE NOT STEEPER THAN 2:1, 14 DAYS ARE ALLOWED.
SLOPES 3:1 OR FLATTER	14 DAYS	7 DAYS FOR SLOPES GREATER THAN 50' IN LENGTH.
ALL OTHER AREAS WITH SLOPES FLATTER THAN 4:1	14 DAYS	NONE, EXCEPT FOR PERIMETERS AND HQW ZONES.

SIGNING FOR RESURFACING PROJECTS

LEGEND
 ┆ STATIONARY SIGN
 ← DIRECTION OF TRAFFIC FLOW

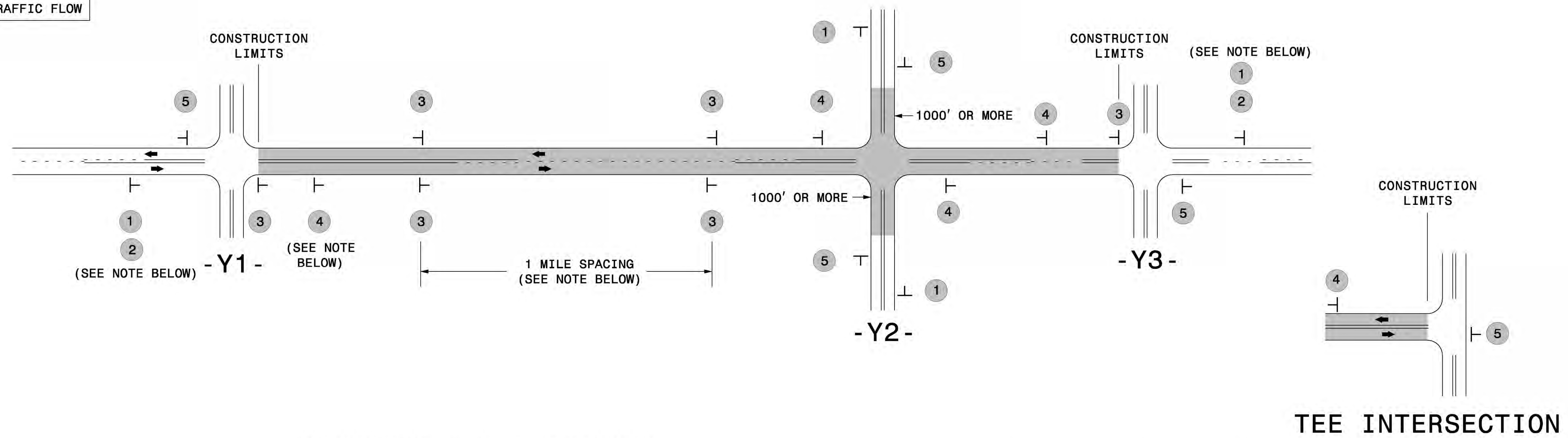

MAINLINE (-L-) SIGNING

-Y- LINE SIGNING

SIGNING NOTES AND PLACEMENT PER DIRECTION	 	<p>PLACE 1000' PRIOR TO BEGINNING OF CONSTRUCTION LIMITS. ONLY USED ON -Y- LINES IF RESURFACING LIMITS EXTEND 1000' ALONG -Y- LINE.</p> <p>#2 SIGN ONLY USED WHEN CONSTRUCTION LIMITS ARE 2 OR MORE MILES IN LENGTH. ROUND UP TO NEXT WHOLE NUMBER. (NO FRACTIONAL OR DECIMAL NUMBERS)</p>	<p>NO REQUIRED STATIONARY SIGNING FOR THE FOLLOWING -Y- LINE CONDITIONS:</p> <ol style="list-style-type: none"> LESS THAN 1000' OF RESURFACING ALONG -Y- LINE SUBDIVISION ROADS DEAD END ROADS <p>WHEN PAVING/CONSTRUCTION ACTIVITIES PROCEED ACROSS AN UNSIGNED -Y- LINE, PORTABLE ADVANCE WARNING SIGNS SHALL BE USED ALONG THE -Y- LINE AS SHOWN BELOW. REMOVE UPON COMPLETION OF WORK.</p> <div style="display: flex; justify-content: space-around;"> <div> PLACED 500' IN ADVANCE OF FLAGGER. </div> <div> PLACED 250' IN ADVANCE OF FLAGGER. </div> </div>
		<ul style="list-style-type: none"> PLACE INITIALLY AT THE CONSTRUCTION LIMITS AND SPACE 1 MILE APART THEREAFTER. AT TEE INTERSECTIONS INSTALL INITIALLY 1/2 MILE FROM INTERSECTION AND SPACE 1 MILE APART THEREAFTER. 	
		<ul style="list-style-type: none"> THESE ARE FOR -Y- LINES THAT ARE "THROUGH" ROADWAYS. DEAD END AND SUBDIVISION ROADS ARE NOT "THROUGH" ROADWAYS. INSTALL 500' +/- FROM EACH -Y- LINE APPROACH AS SHOWN ABOVE. FOR MULTIPLE -Y- LINES THAT ARE SEPARATED BY 0.25 MILES OR LESS, TREAT AS A SINGLE UNIT AND INSTALL WITHIN 500' OF EACH APPROACH. A MAXIMUM OF 2 SIGN SETS PER MILE. DO NOT INSTALL WHEN -Y- LINES ARE WITHIN 0.5 MILES FROM "END ROAD WORK" SIGN. FOR TEE INTERSECTIONS, INSTALL WITHIN 500' +/- OF THE INTERSECTION ALONG -L- LINE. 	
		<p>PLACE 500' FOLLOWING THE END OF CONSTRUCTION LIMITS OR AS SHOWN WHEN WORK ENDS AT A 3-WAY TEE INTERSECTION.</p>	
	<p>THE ABOVE SIGNS ARE ALL THAT ARE REQUIRED FOR A CONTRACTOR TO BEGIN A RESURFACING CONTRACT. ANY ADDITIONAL SIGNS REQUESTED BY NCDOT DIVISIONS SHALL BE INSTALLED WITHIN 7 BUSINESS DAYS OF THE START OF CONTRACT WORK.</p>		

MAPS LESS THAN 2 MILES

FOR RESURFACING MAPS WITH CONSTRUCTION LIMITS LESS THAN 2 MILES IN LENGTH, NO STATIONARY SIGNS ARE REQUIRED. USE PORTABLE "ROAD UNDER CONSTRUCTION" OR "ROAD WORK AHEAD" SIGNS IN LIEU OF STATIONARY ADVANCE WARNINGS SIGNS.

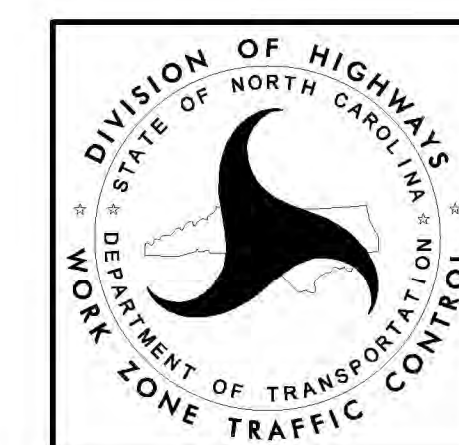

ADVANCE WARNING SIGNS FOR RURAL AND SUBURBAN 2-LANE ROADWAY RESURFACING

5/15/2017 5:11:10 PM \\NCDOT\resurfacing\212W & AST Resurfacing Details\Resurfacing_AdvWarn_212W.dgn User:keads